

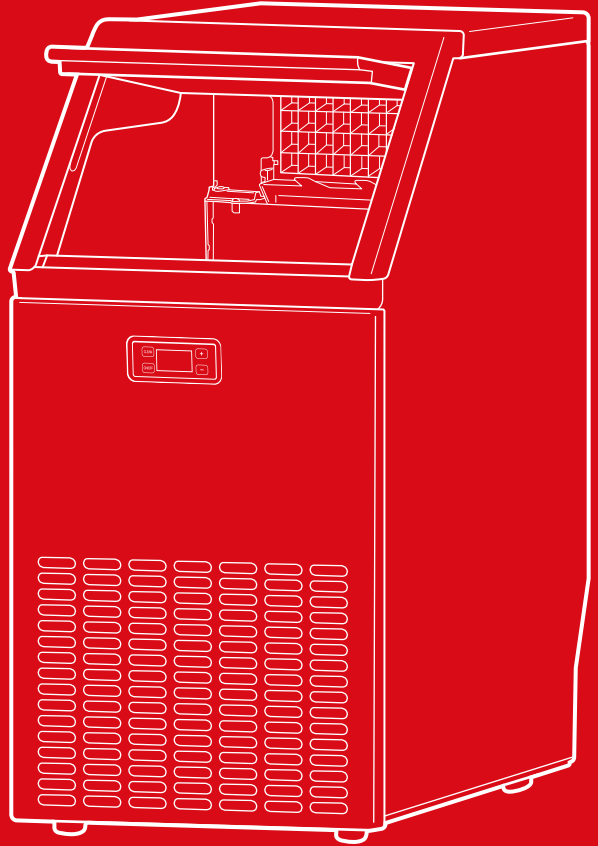

bestchoiceproducts



# INSTRUCTION MANUAL

---

Commercial Ice Maker

## **!** NOTICE

Please retain these instructions for future reference.

- This unit is intended for indoor use only.
- Place unit on a stable and level surface.
- Keep unit away from direct sunlight and other sources of heat.
- Using an extension cord is not recommended as it may overheat and cause a risk of fire.
- Keep ventilation openings clear of obstruction.
- This appliance is intended for household use and similar applications such as staff kitchen areas in shops, offices and other working environments; by clients in hotels, motels and other residential type environments; catering and similar non-retail applications.
- Unplug the machine before fitting, removing, or cleaning parts.
- This appliance is not intended for use by persons (including children) with reduced physical, sensory or mental capabilities, or lack of experience and knowledge, unless they have been given supervision or instruction concerning use of the appliance by a person responsible for their safety.
- If any parts are missing, broken, damaged, or worn, stop using this product until repairs are made and/or factory replacement parts are installed.
- Do not use this item in a way inconsistent with the manufacturer's instructions as this could void the product warranty.

## **WARNING**

- Do not let children play with this machine.
- Unit must be room temperature before use.
- Do not damage the refrigerant circuit.
- Only use the 110-120V/60Hz earthed power supply.
- Do not store explosive substances such as aerosol cans with a flammable propellant in this appliance.
- This unit must be positioned so that the plug is accessible. Do not run cord over carpeting, rugs, or similar materials.
- Do not place anything over the cord. Keep cord away from traffic areas.
- Do not submerge cord in water.
- No other appliance should be plugged into the same outlet. Make sure that the plug is fully inserted into the outlet.
- Never unplug you unit by pulling on the power cord. Always grasp the plug firmly and pull it straight out from the outlet.
- Do not tip the machine over or lay it on its side.
- Do not use liquids other than water to make ice cubes.
- Do not place anything on top of the unit.
- Do not place anything inside the ice bin other than ice. Do not place wine or beer bottles in the ice bin.

## **BEFORE FIRST USE**

1. Remove all packaging and accessories.
2. Clean the ice scoop, cabinet, and inner parts that contact water with mild detergent, warm water, and a soft cloth.
3. Place unit on a stable and level surface. Make sure that there is at least 15 cm of space between the back of the unit and the wall, and at least 5 cm on each side. Keep the front accessible and the air outlet clear of obstructions.
4. Place unit in position for at least 4 hours to settle the refrigerant fluid. Do not plug it in.

## PARTS

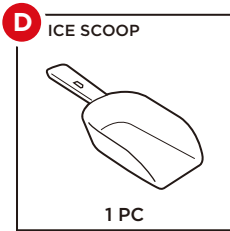
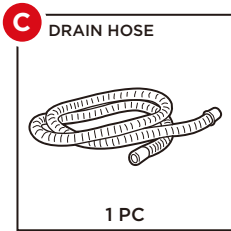
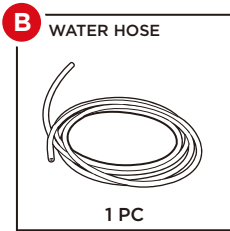
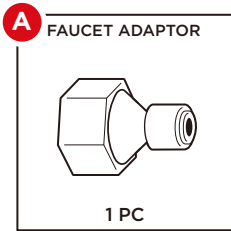

## DIAGRAM

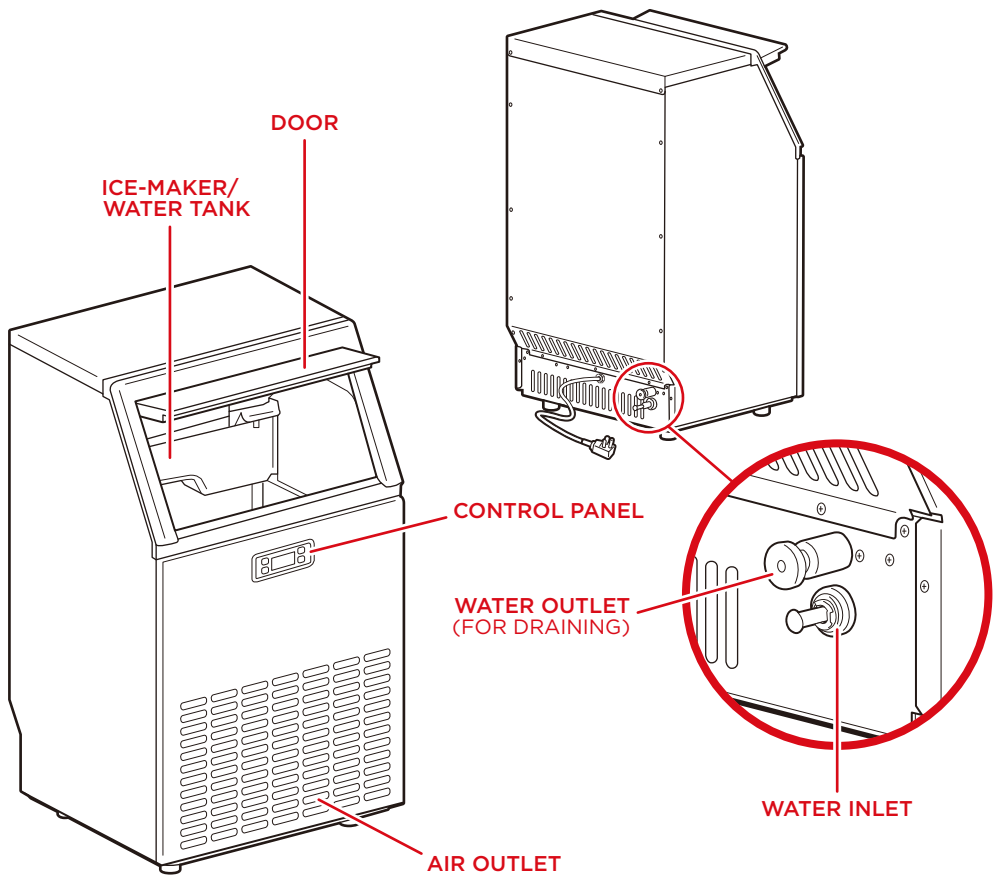

## ICE MAKER/WATER TANK

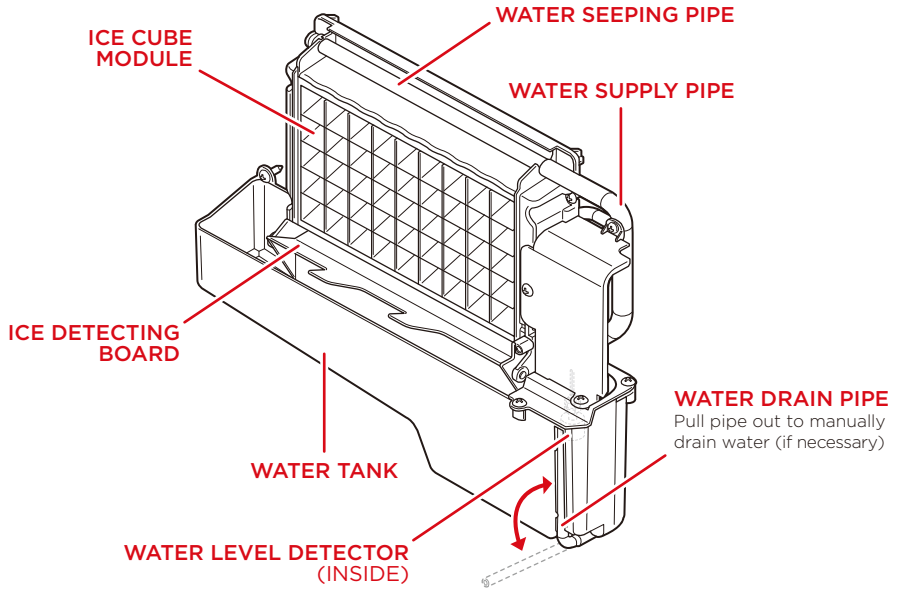

## CONTROL PANEL

**TIMER/CLEAN:** Press to set the timer. Press and hold to enter cleaning mode.

**ON/OFF:** Press to turn unit on/off or cancel timer. Press and hold to forcefully switch from ice making to ice harvesting.

**WATER FLOWING/ADD WATER:** Flashing icon indicates water is flowing and solid icon indicates water shortage.

**ICE FULL:** Remove ice to resume ice making

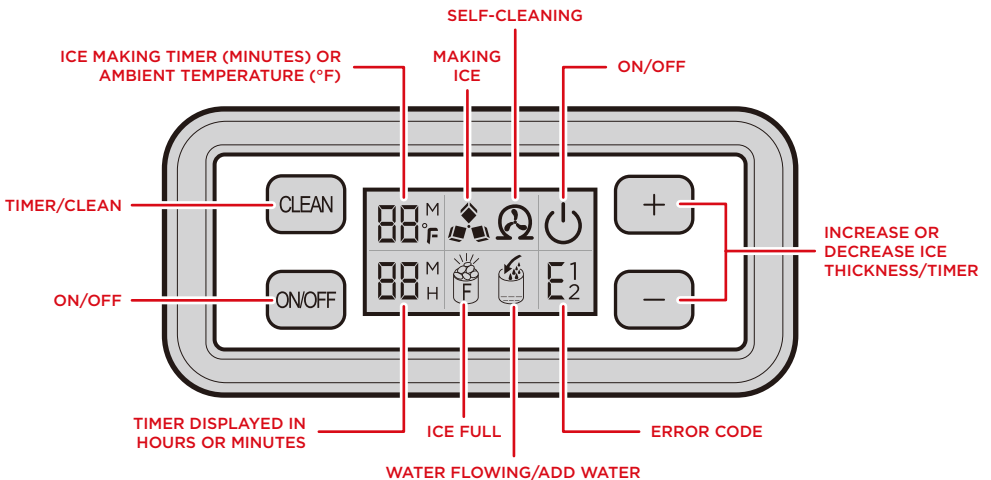

## SETTING UP THE ICE MAKER

1. Remove the locking ring from the water inlet. Compress the plug, then remove it.
2. Insert the part B water hose into the water inlet and secure it by replacing the locking ring.

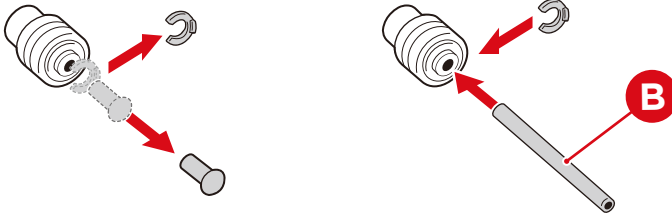

3. Screw the part A faucet adaptor onto the water faucet. Remove the locking ring.
4. Insert the other end of the water hose into the faucet adaptor and secure it by replacing the locking ring.

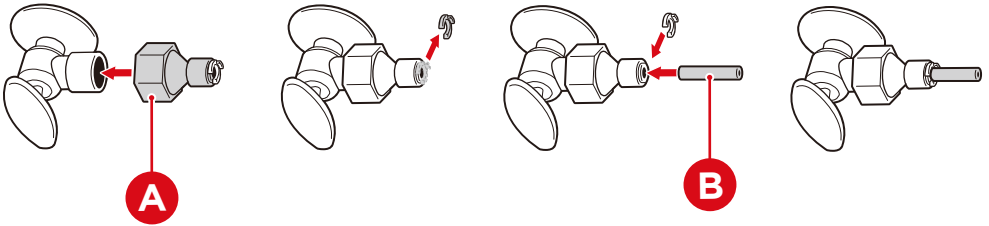

5. Remove the plug from the water outlet. Attach one end of the part C drain hose to the water outlet and attach the other end to your water drainage pipeline.  
*NOTE: Pull the water drain pipe out from within the ice maker to manually drain water.*
6. Plug the power cord into a wall outlet.

## USAGE TIPS

- The ice maker requires a continuous water supply with pressure 1-8 bar.
- The temperature of the water feeding into the ice maker should be between 41°F and 77°F for proper operation.
- Connect to a potable water supplying only. Only use drinking water.
- It is recommended that you discard the first batch of ice.

## OPERATING INSTRUCTIONS

1. Press the **ON/OFF** button to turn on the ice maker and it will automatically start filling the water tank to begin the ice making process.
2. The top left display will show the ambient temperature (°F) or the time left in the ice making cycle (minutes).
3. Ice making will continue until the unit is turned off, at maximum capacity, or there is insufficient water.  
*NOTE: The initial ice making cycle may take up to 30 minutes, but a typical cycle is approximately 11 to 20 minutes.*
4. Press the **+** and **-** buttons to adjust ice thickness by increasing or decreasing the time of the ice making cycle (i.e. for thicker ice increase time and for thinner ice decrease time).

## SETTING TIMER

1. Press the **TIMER/CLEAN** button, then use the **+** and **-** buttons to increase or decrease time.
2. When in standby mode, the timer sets the time until the ice making process begins.
3. When in ice making mode, the timer set the time until the ice making process ends.
4. To adjust or cancel a timer, press the **TIMER/CLEAN** button and increase/decrease the time.

## SELF-CLEANING MODE

- Press and hold the **TIMER/CLEAN** button to enter self-cleaning mode which lasts for 20 minutes. The machine will pump water through the unit to clean it.
- After 20 minutes, the water pump will stop and the unit will automatically refill the water tank.

## CLEANING AND STORAGE

- To put the ice maker into long storage, do the following:
  1. Turn off the unit, unplug it, and remove all the ice cubes.
  2. Shut off the main water supply, then remove the water hose from the water inlet and faucet.
  3. Pull the water drain pipe out from within the ice maker to manually drain water. Remove the drain hose and replace the water outlet plug.
  4. Dry the interior and exterior with a soft cloth. Leave the door open to allow for air circulation.
  5. If necessary, cover the unit with a tarp or plastic bag.
- Unplug the machine before cleaning or storage.
- Do not clean your ice maker with alcohol or flammable fluids.
- Wipe the outside of the ice maker regularly with a soft cloth, mild detergent, and warm water.
- Wipe the inside with a soft cloth and solution of 28g of household bleach or chlorine and 7.5L of hot water. Rinse thoroughly and drain the water.
- The water seeping pipe, water tank, and ice detecting board must be cleaned periodically with a natural cleaner and water. Pull the water seeping pipe up and outwards to remove it. Rinse thoroughly and drain the water.
- Every 6 months you may want to deep clean the ice machine with a **nickel-safe ice machine cleaner**.

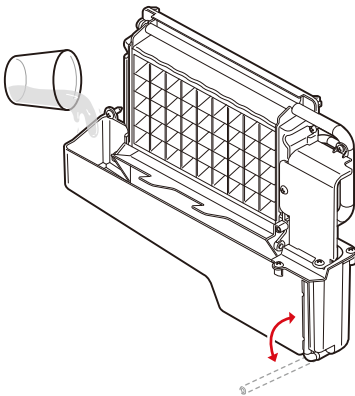

1. Mix 300ml of cleaner with 2.8L of warm water, then divide it into 2 containers.
2. Pour one container of the cleaning solution into the water tank and wait 5 minutes.
3. Turn on the unit and run the self-cleaning mode. Manually drain the water.
4. Repeat steps 1-3 with the other container of cleaning solution.
5. Run a normal self-cleaning mode twice to flush out the cleaning solution. Manually drain the water after every self-cleaning mode.

- It is recommended that you discard the batch of ice after cleaning.

## ERROR CODES

**E1:** Ambient temperature sensor not functioning

**E2:** Ice making problem or leak

**E3:** Ambient and suction tube temperature sensors not functioning

**E4:** Ice making cycling is longer than 35 minutes indicating no refrigerant or a non-functioning compressor

**ICE FULL ICON ALWAYS ON:** Magnetic control switch cutoff

## TROUBLESHOOTING

Problem	Reason	Solution
Add water indicator on	No water supply	Turn on water, increase water pressure, or clean water hose
	Water level detector not functioning	Clean water tank and water level detector
	Water leaking from water tank	Make sure unit is level
	Water leaking from drain hose	Reinstall drain hose
Add water indicator flashing but not water flow	Low water pressure or blocked water hose	Increase water pressure or clean water hose
Pump working but no water flow from water seeping pipe	Clogged water seeping pipe	Clean holes on the water seeping pipe
Cloudy ice cubes	Bad water quality	Change water supply/filter water
Irregular ice cubes	Bad water quality or dirty water tank	Change water supply/filter water, or clean water tank
	Clogged water seeping pipe	Clean holes on the water seeping pipe
Thin ice cubes	High ambient temperature	Move to a lower ambient temperature or increase ice making time
	Bad air circulation	Place unit at least 15 cm from the wall
Thick ice cubes	Low ambient temperature	Reduce ice making time
Full indicator on	Ice bin full	Remove ice cubes
Ice making cycle normal but no ice cubes	High ambient temperature or water temperature too high	Move to a lower ambient temperature or switch to a colder water supply

**ENJOY YOUR PRODUCT!**

bcp



## PRODUCT WARRANTY INFORMATION

All items can be returned for any reason within 60 days of the receipt and will receive a full refund as long as the item is returned in its original product packaging and all accessories from its original shipment are included. All returned items will receive a full refund back to the original payment method. All returned items will not be charged a re-stocking fee.

All returned items require an RA (Return Authorization) number, which can only be provided by a Best Choice Products Customer Service Representative when the return request is submitted. Items received without an RA may not be accepted or may increase your return processing time. Once an item has been received by Best Choice Products, refunds or replacements will be processed within 5 business days.

All returns must be shipped back to the Best Choice Products Return Center at the customer's expense. If the reason for return is a result of an error by Best Choice Products then Best Choice Products will provide a pre-paid shipping label via email. Boxes for return shipping will not be provided by Best Choice Products, and is the customer's responsibility to either use the original shipping boxes or purchase new boxes.

Pictures may be required for some returns to ensure an item is not damaged prior to its return. Items returned are not considered undamaged until they are received by Best Choice Products and verified as such. All damages to items are the customer's responsibility until the item has been received by and acknowledge by Best Choice Products as undamaged.

## CONTACT US; WE'RE HERE 7 DAYS A WEEK TO HELP YOU!



[bestchoiceproducts.com](https://bestchoiceproducts.com)



[customerservice@bestchoiceproducts.com](mailto:customerservice@bestchoiceproducts.com)



844.948.8400



[LEARN MORE!](#)

## **WARNING**

Manufacturer and seller expressly disclaim any and all liability for personal injury, property damage or loss, whether direct, indirect, or incidental, resulting from the incorrect attachment, improper use, inadequate maintenance, or neglect of this product.